



Queens Gate Terrace

, South Kensington, SW7 5PF

£1,250 Per Week

A well refurbished three double bedroom apartment situated on the Raised Ground floor of a delightful stucco fronted building in one of London's finest locations.

This fine property comprises of:- Entrance hallway, spacious reception/dining room with wonderful high ceilings, separate fitted kitchen with large window, three double bedrooms each with fitted wardrobes, modern bathroom/WC and one shower/WC. The property also benefits from having large windows with many original features and is located only moments from V & A., the Natural Museum, Royal Albert Hall, Hyde Park and within a short walk to both South Kensington underground and Gloucester Road stations, with Knightsbridge shopping haven and Kensington High Street are also within easy reach. This fabulous family property is offered furnished and is available 3rd of August 2026 . NO PETS POLICY PLEASE..

- Full refurbishment
- Available now
- Three Double Bedrooms
- Two Brand new bathrooms
- Raised ground floor
- Newly fitted separate kitchen

Viewing

Please contact our Messila Residential Office on 020 7586 6699 if you wish to arrange a viewing appointment for this property or require further information.



3



2



1



C

Floor Plan

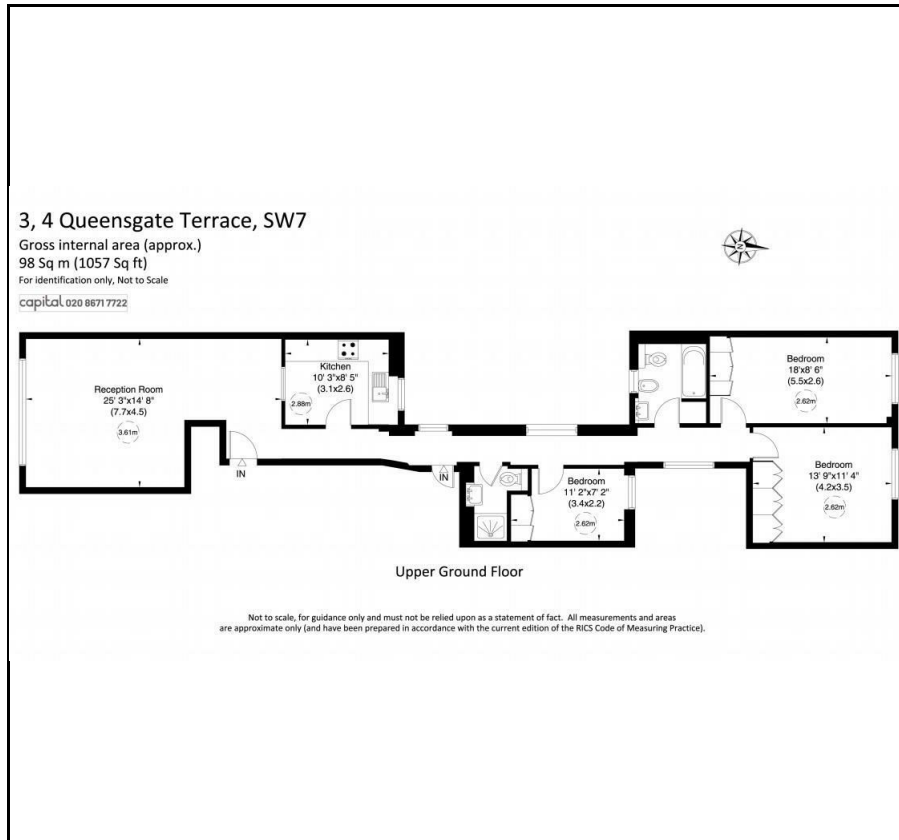

Area Map



Energy Efficiency Graph

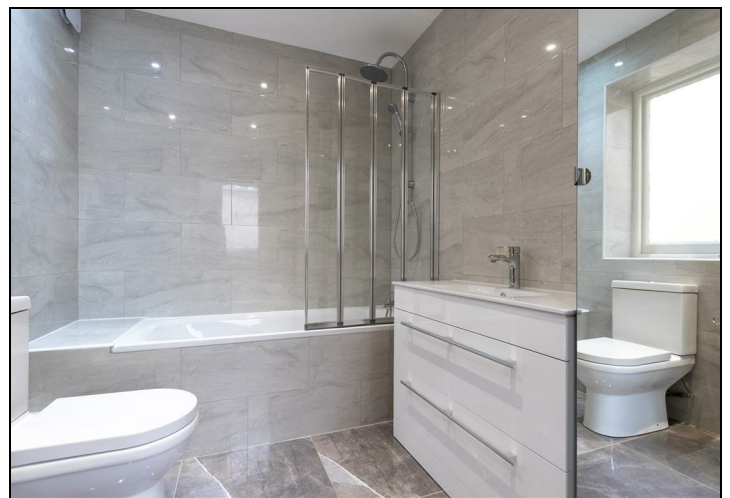
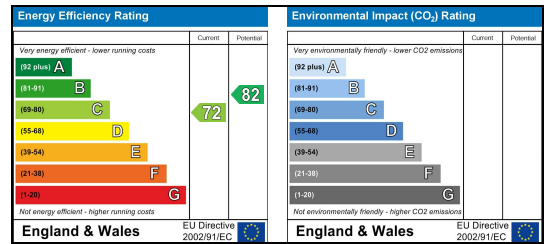

These particulars, whilst believed to be accurate are set out as a general outline only for guidance and do not constitute any part of an offer or contract. Intending purchasers should not rely on them as statements of representation of fact, but must satisfy themselves by inspection or otherwise as to their accuracy. No person in this firm's employment has the authority to make or give any representation or warranty in respect of the property.

Messila Residential

137 Park Road, London, NW8 7HT

T: 020 7586 6699 E regentspark@messilaresidential.com W: messilaresidential.com